

Descrição: CH - 3/16" (4,76MM) ASTM A36

Desenho N° 2.02.239P

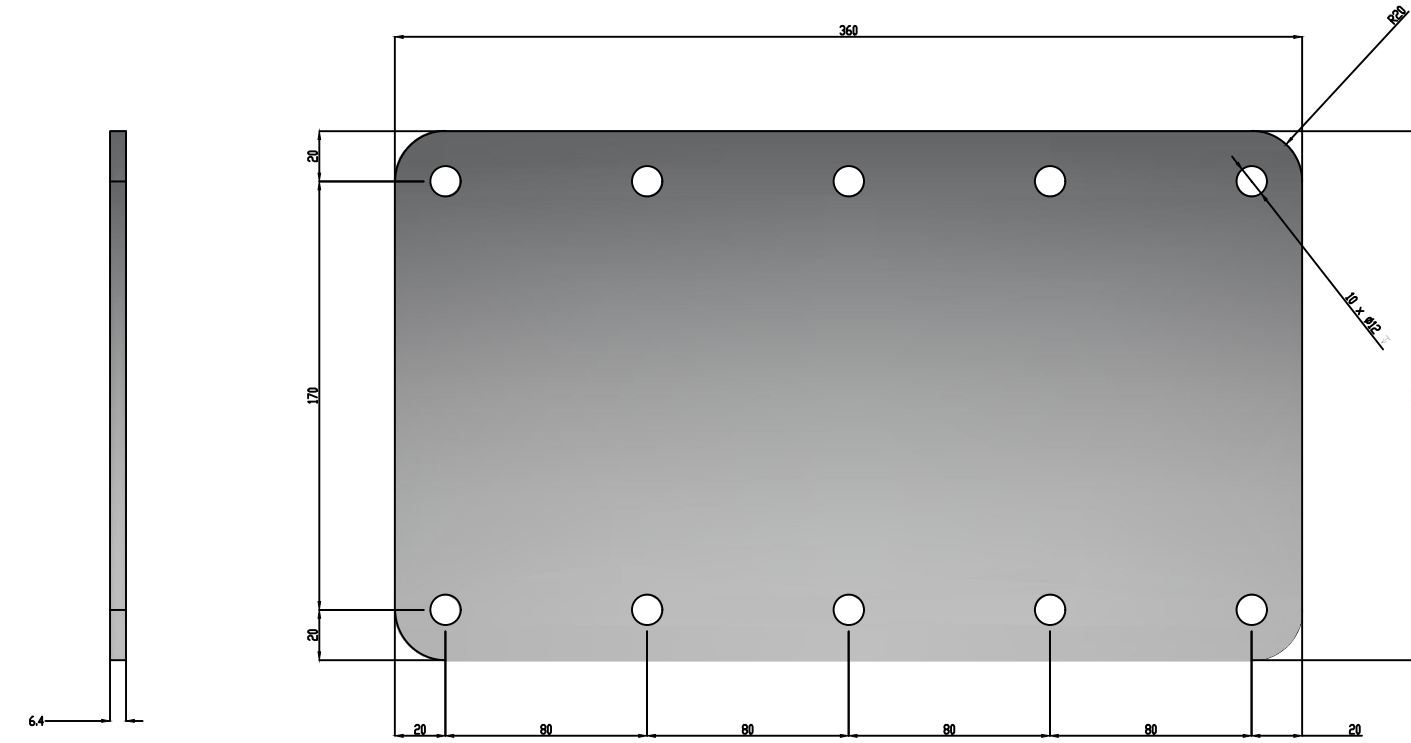

Descrição: CH - 1/4" (6,35MM) ASTM A36

Desenho N° 2.02.148P

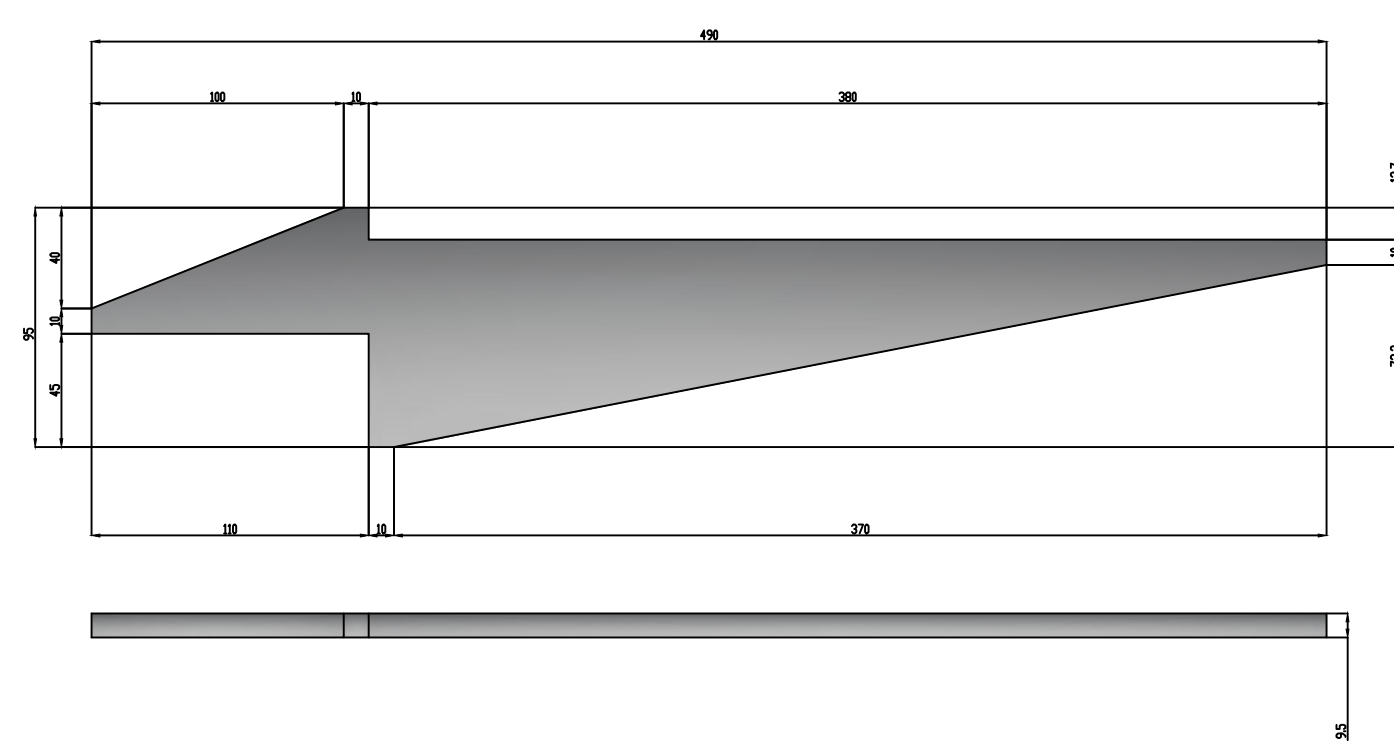

Descrição: CH - 3/8" (9,53MM) ASTM A36

Desenho N° 2.02.108P

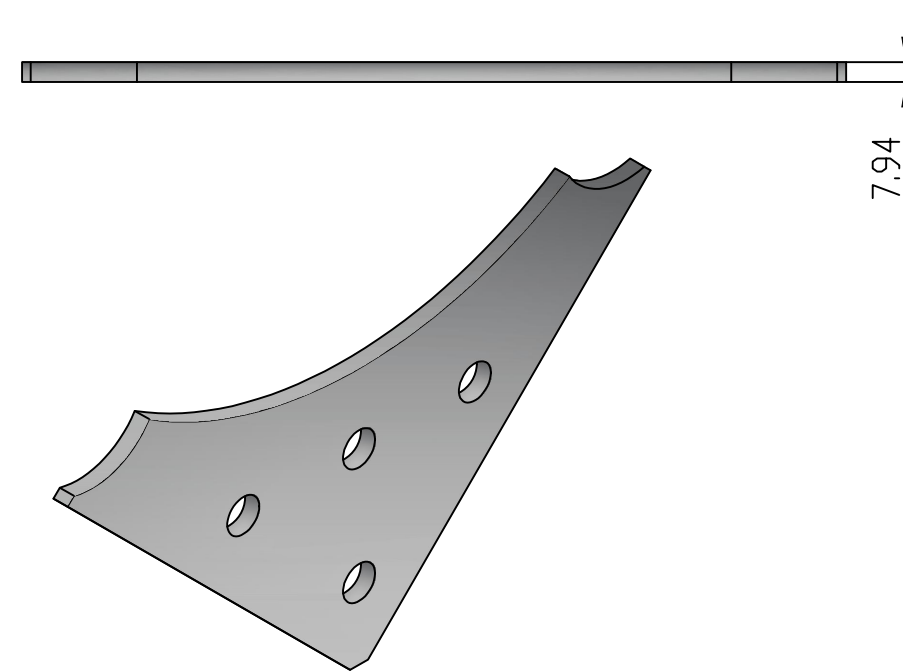
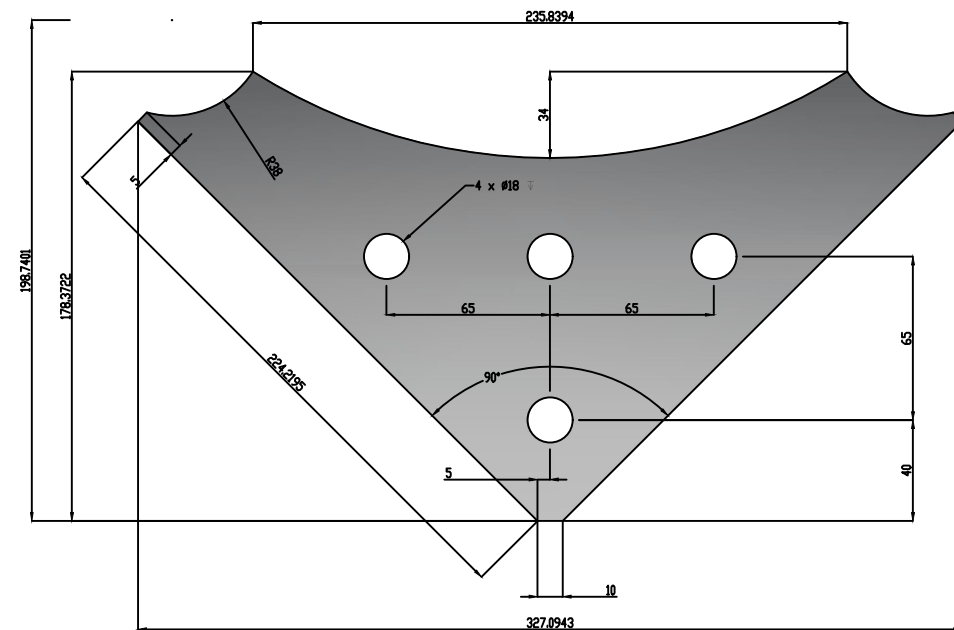

Descrição: CH - 5/16" (7,94MM) ASTM A36

Desenho N° 2.02.011P

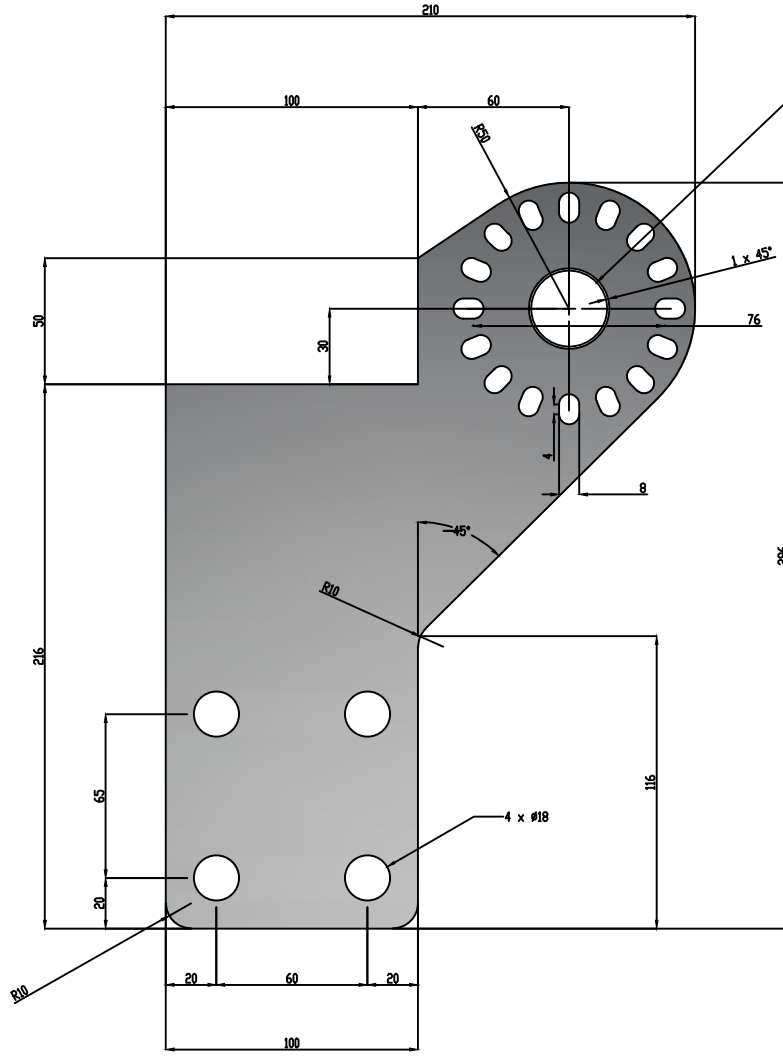

Descrição: CH - 3/8" (9,53MM) ASTM A36

Desenho N° 2.02.231P

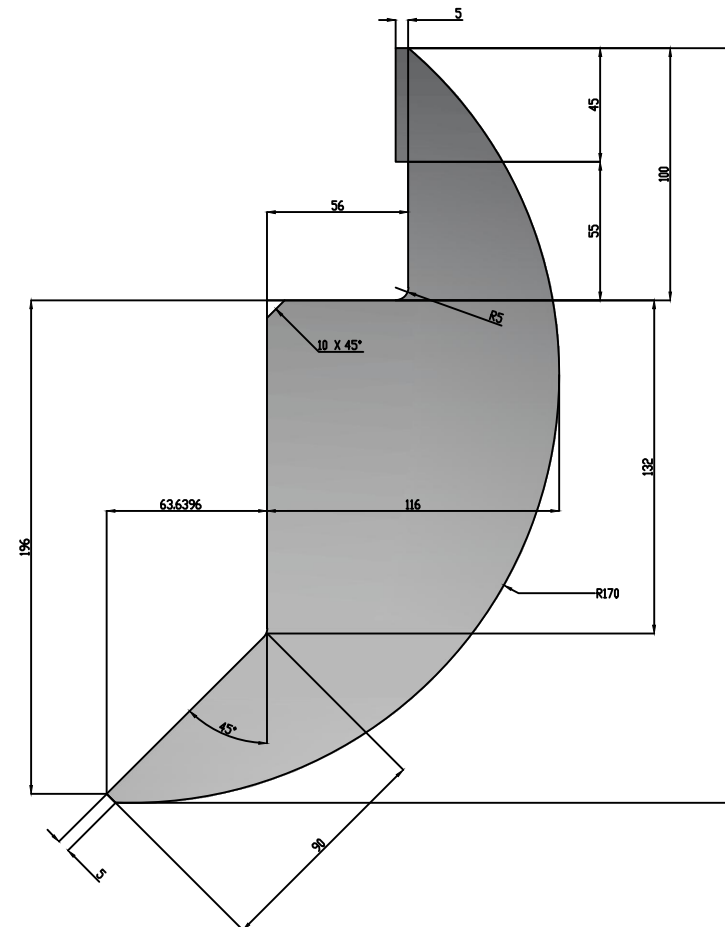

Descrição: CH - 3/16" (4,76MM) ASTM A36

Desenho N° 2.02.195P

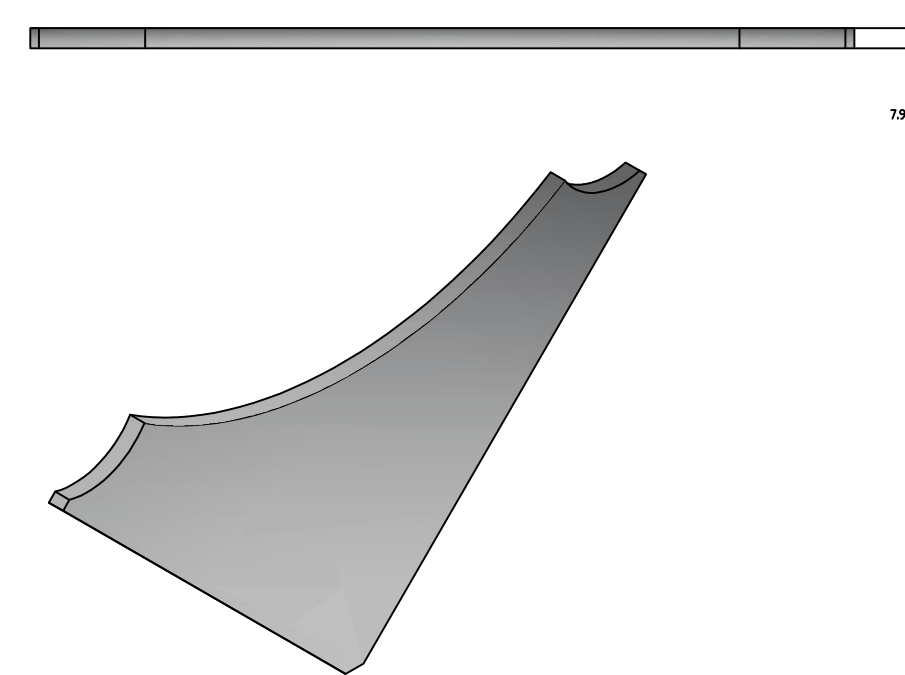
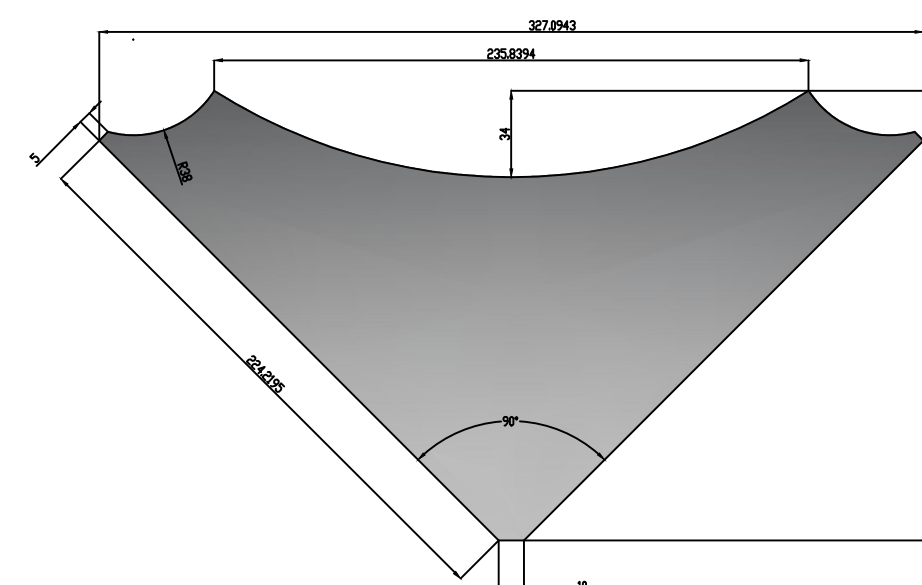

Descrição: CH - 5/16" (7,94MM) ASTM A36

Desenho N° 2.02.008P

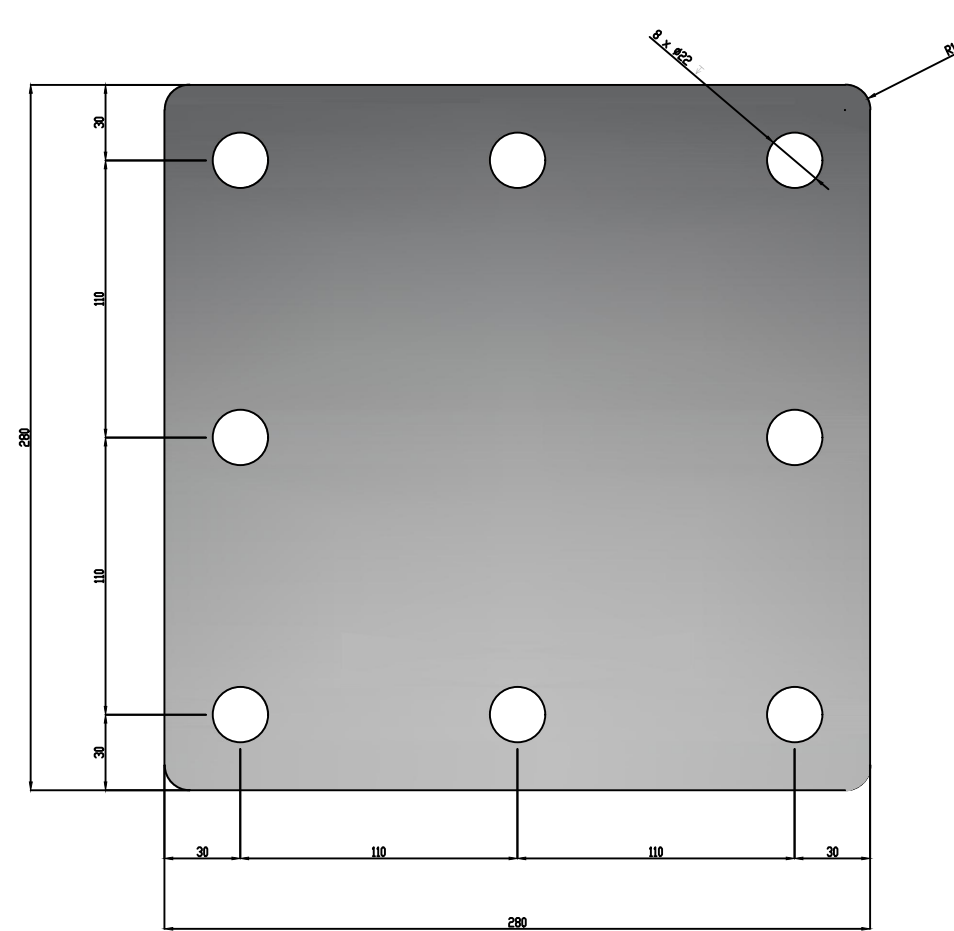

Descrição: CH - 3/8" (9,53MM) ASTM A36

Desenho N° 2.02.035P

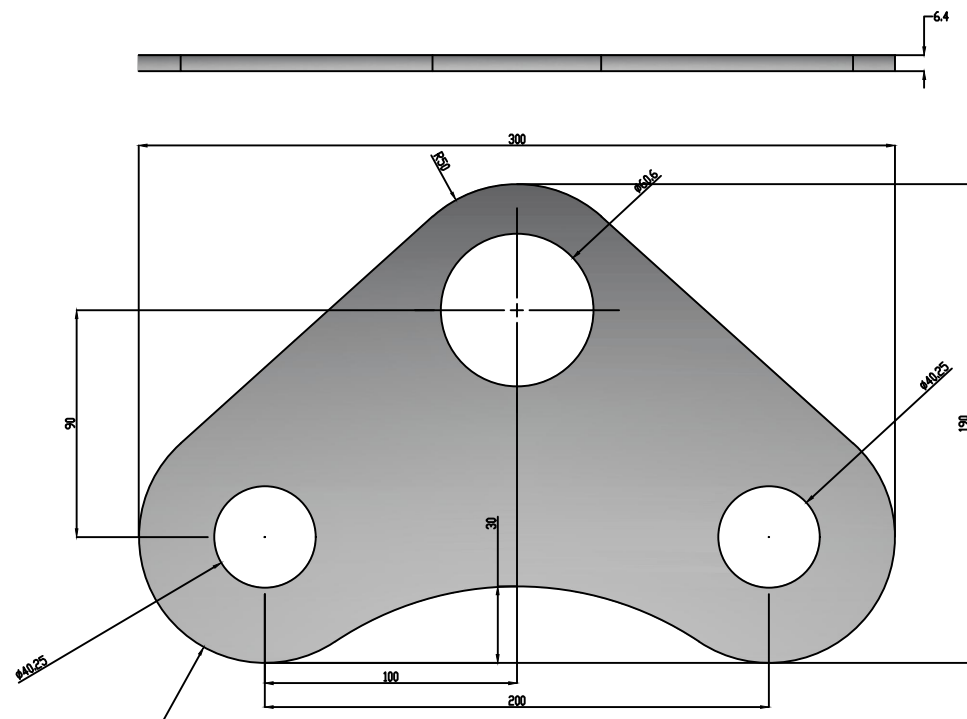

Descrição: CH - 1/4" (6,35MM) ASTM A36

Desenho N° 2.02.184P

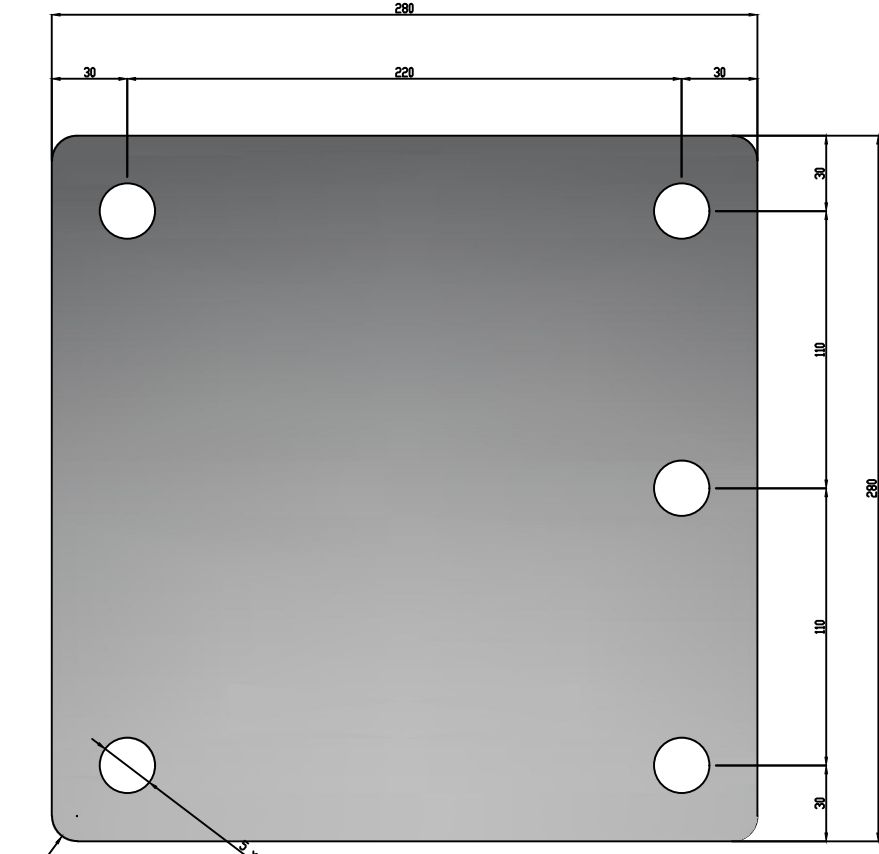
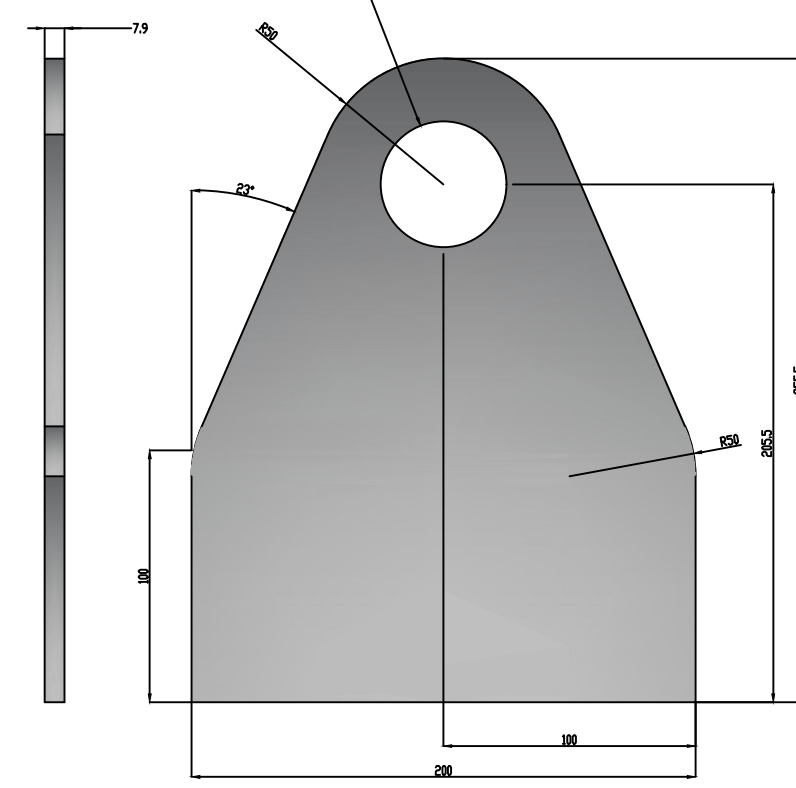
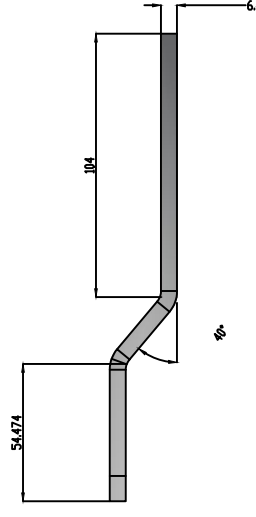
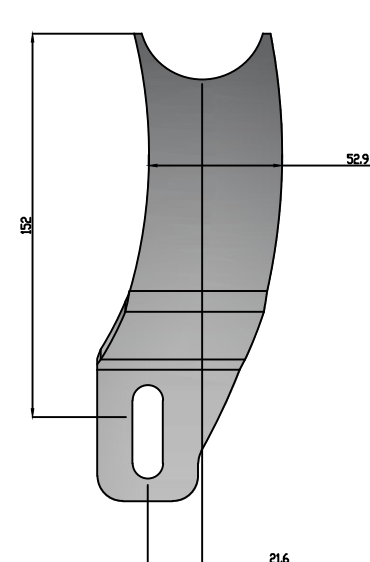
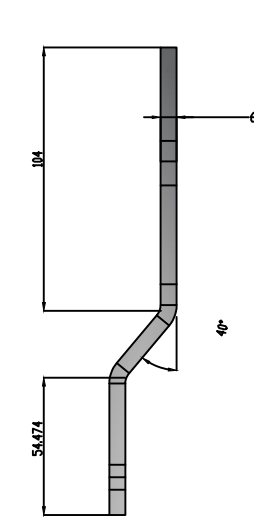
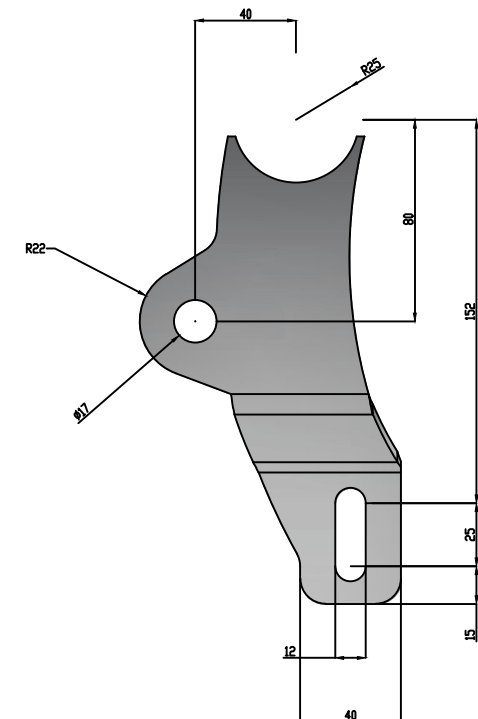

Descrição: CH - 3/8" (9,53MM) ASTM A 36

Desenho N° 2.02.127P

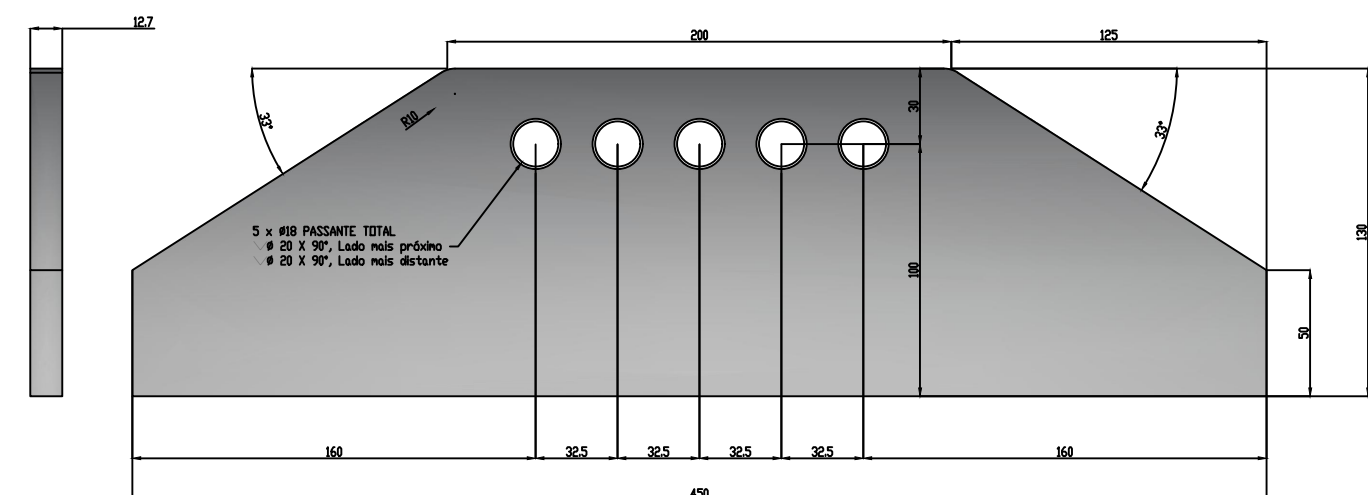

Descrição: CH - 1/2" (12,7MM) ASTM A36

Desenho N° 2.02.222P

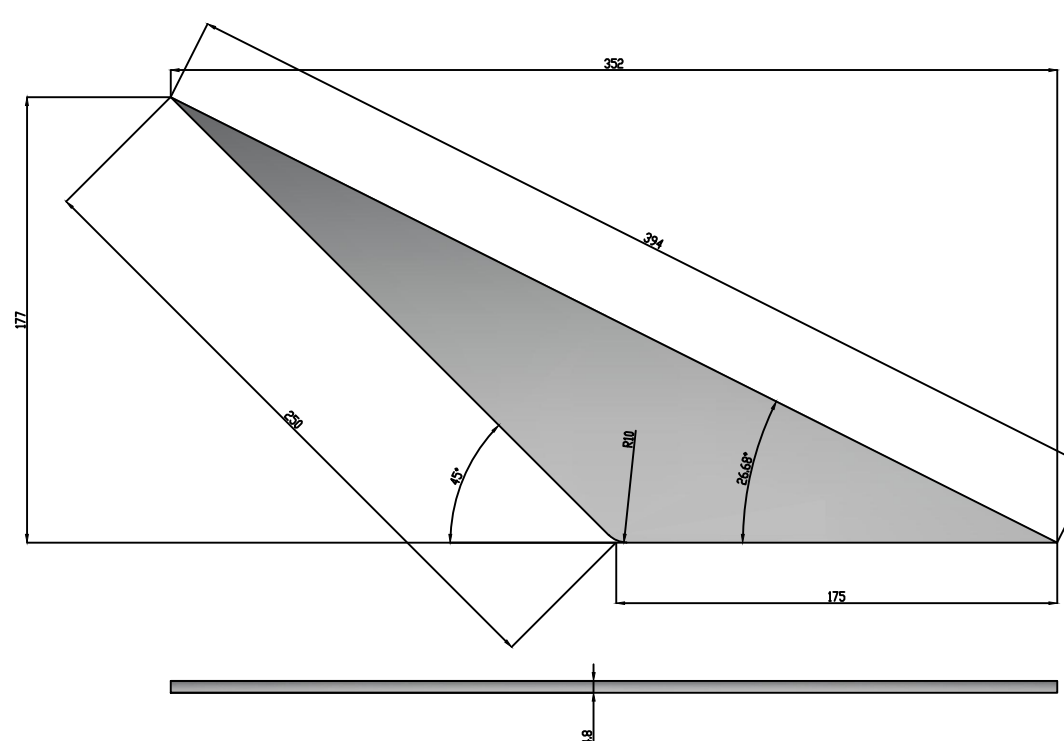

Descrição: CH - 3/16" (4,76MM) ASTM A36

Desenho N° 2.02.171P

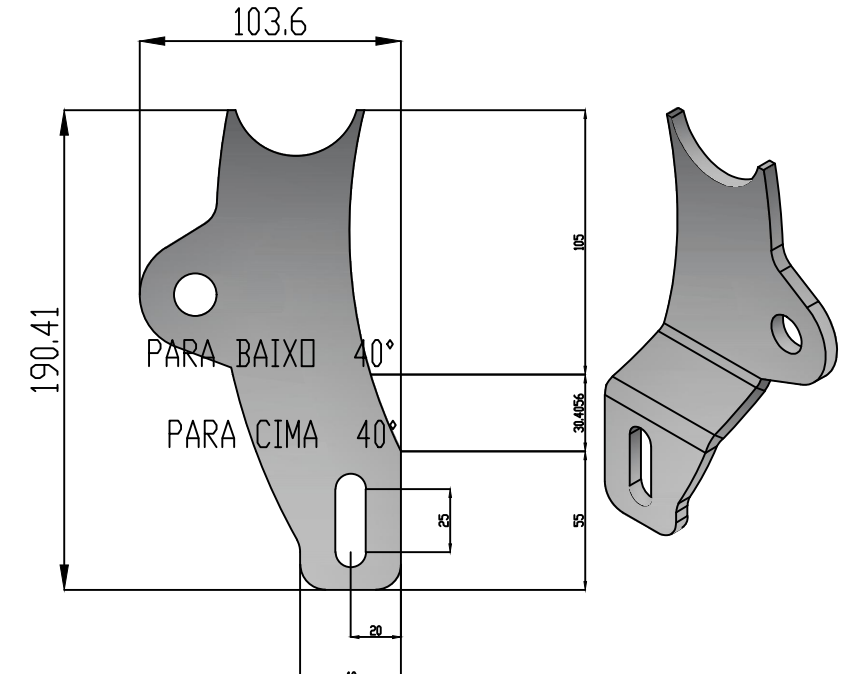

Descrição: CH - 1/4" (6,35MM) ASTM A36

Desenho N° 2.02.235P

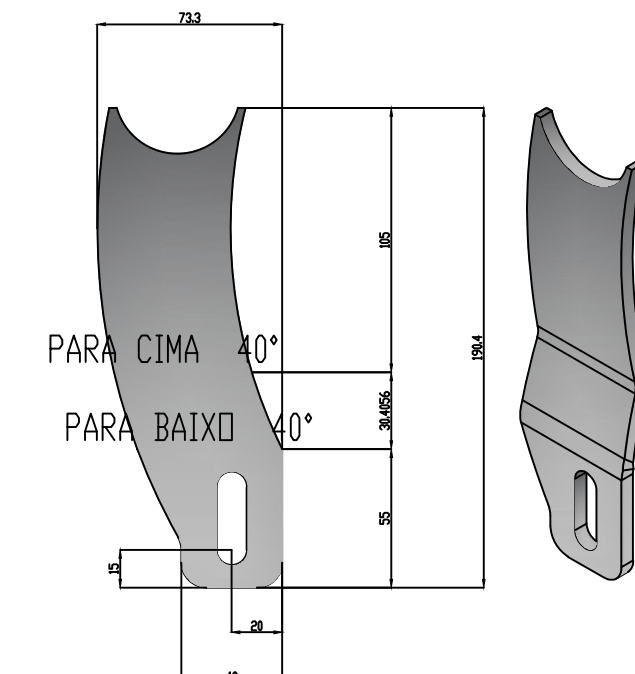

Descrição: CH - 1/4" (6,35MM) ASTM A36

Desenho N° 2.02.219P

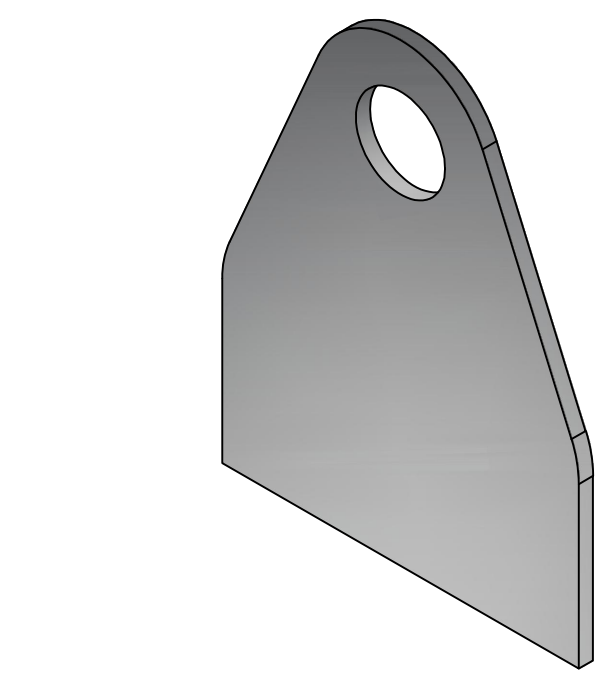

Descrição: CH - 5/16" (7,94MM) ASTM A36

Desenho N° 2.02.283P



Estado de Mato Grosso do Sul
Prefeitura do Município de Costa Rica
Secretaria de Transportes, Urbanização e Obras públicas

Execução de infraestrutura turística (plano inclinado) no Parque municipal Salto do Sucuriú no município de Costa Rica/MS, objeto do convênio SICONV 955044/2023 operação 1092455-10, com repasse do Ministério do Turismo e contrapartida financeira do município.

Resp. Téc.		PREFEITURA MUNICIPAL DE COSTA RICA	
Projeto nº		Aprovado em	
Emanuel Santos Souza Engenheiro Civil CREA Nº 5069949210		Data 11/2025	
Proprietário:		Folha 03/05	
Município de Costa Rica-MS. CNPJ: 15.359.000/0001-30 Cleverson Alves dos Santos RG nº 1.878.103-3/SRP/DF - CPF nº 848.171.485-00 Prefeito Municipal		Escala 1:3	